

Model: IKRN5-040 - RENTAL RANGE

400/230 V - THREE-PHASE | 1.500 R.P.M. | 50 Hz

RENTAL Genset with manual control panel.



SMART POWER
(UE) 2016/1628

Image for guidance purposes.

PRP

CONTINUOUS POWER: 33 kVA

PRP "Prime Power" norma ISO 8528-1

LTP

STAND-BY POWER: 37 kVA

LTP "Limited Time Power" norma ISO 8528-1

ENGINE

MAKE	MODEL
KOHLER	KDI1903TCRCAC-SV

ALTERNATOR

MAKE	MODEL
MECC-ALTE	ECP32-3S/4

VOLTAGE	HZ	PHASE	COS Ø	PRP kVA/kW	LTP kVA/kW	AMP. (LTP)
400/230	50Hz	3	0,8	33,5/26,8	36,6/29,3	52,83

Rev.: 16/12/2019

Model: IKRN5-040 - RENTAL RANGE

400/230 V - THREE-PHASE | 1.500 R.P.M. | 50 Hz

ENGINE CHARACTERISTICS

MAKE	MODEL
KOHLER	KDI1903TCRCAC-SV

General Data

Power PRP (kWm)	30.3
Power LTP (kWm)	33.3
No. cylinders	3
Cylinder capacity (L)	1.9
Diameter per stroke (mm)	88 x 102
Compression ratio	17.4
Cooling system	LIQUID
Injection	COMMON RAIL
Suction	TURBO-INTERC.
Series regulator	ELECTRONIC
Fly wheel coupling	4-7.5

Lubrication system

Oil capacity (L)	8.90
Oil consumption (%)	0.10
Min. alarm oil pressure (bar)	0.80

Ventilation system

Air cooling flow (m ³ /h)	8050
Combustion air flow (m ³ /h)	138
Max. back pressure for fan (mbar)	

Exhaust system

Exhaust gas flow (m ³ /h)	170
Exhaust back pressure (mbar)	70
Temp. exhaust gases (°C)	400

Electrical system

VDC (V)	12
Battery (Ah)	60
Engine start-up (kW)	2.2

Rev.: 16/12/2019

Model: IKRN5-040 - RENTAL RANGE

400/230 V - THREE-PHASE | 1.500 R.P.M. | 50 Hz

ALTERNATOR CHARACTERISTICS

MAKE	MODEL
MECC-ALTE	ECP32-3S/4

General Data

Power PRP (kVA)	42.5
Power LTP (kVA)	48
Efficiency Alt. 100 %	88.4
Efficiency Alt. 110 %	88
No. Poles	4
Voltage regulator	DSR
No. wires	12
Insulation	H
Xd (%)	333.3
X'd (%)	15.6
X	11.7
Degree of protection	IP23

GENERATOR SET CONSUMPTION

% POWER USED	LITRES/HOUR
50%	4.2
75%	6.2
100%	8.1

DIMENSIONS, CAPACITIES, APPROXIMATE WEIGHT

Dimensions (mm)		
LENGTH	WIDTH	HEIGHT
2555	1160	1630

FUEL TANK (LITRES)	WEIGHT (KG)
250	1400

NOISE LEVEL (dB (A))
60dB(A)@7m

Rev.: 16/12/2019

Model: IKRN5-040 - RENTAL RANGE

400/230 V - THREE-PHASE | 1.500 R.P.M. | 50 Hz

INMESOL GENERATOR SET

GENERAL DESCRIPTION

The “INMESOL” generator set is an electrical energy generating machine which is used in places where there is **no mains supply** or when there is a MAINS failure.

The mobile elements, distribution belt, fan, etc., and those parts which reach high temperatures during operation, exhaust manifold, etc, include their corresponding protections, in compliance with the requirements of the Machinery Directive **2006/42**.



INMESOL S.L company with ISO 9001 quality certification system for the:

Design, manufacture, marketing and technical assistance of power GENSETS, lighting towers, welding GENSETS, tractor with PTO GENSET and hybrid generation systems.

Europe regulations:

Inmesol power GENSET sets comply with European legislation and were given the CE marking which includes the following directives:

- 2006/42/EC on machinery safety.
- 2005/88/EC on NOISE EMISSIONS by equipment for outdoor use (amends the 2000/14/EC).
- 2014/30/UE on Electromagnetic Compatibility.
- 2014/35/UE on electrical safety, electrical equipment designed to be used within certain voltage limits

International regulations:

Upon request, INMESOL can supply equipment that complies with the International Legislation and Regulations:

- “Technical Regulation on Safety of Machinery & Equipment” No. 753, repealing GOST R standards for exports to Russia.
- Resolution nº 90708 dated August 30th 2013 “Reglamento Técnico de Instalaciones Eléctricas RETIE” issued by the Ministry of Mining and Energy, Section 20.21 Engines and power generators, for exports to Colombia.

Information:

The power ratings are for reference to environmental conditions: barometric pressure 100 kPa, 25°C and 30% relative humidity. These are defined by ISO 8528 and ISO 3046.

PrimePower (PRP) “Main Service” is applicable for power GENSETS that function as main electric power source. It may be overloaded by 10% in limited time points, maximum once every 12 hours.

StandbyPower (LTP) “Emergency Service” applies to power GENSETS that run during Electrical Grid failure. This power may NOT BE OVERLOADED.

Nevertheless, to obtain long engine life, it is recommended that the active power average load (kW) connected to the power GENSET set in any period of 24 hours of operation does not exceed the following values:

- In Main Service 70% of the PRP power.
- In Emergency Service during Electrical Grid failure 80% of the LTP power.

Rev.: 16/12/2019

Model: IKRN5-040 - RENTAL RANGE

400/230 V - THREE-PHASE | 1.500 R.P.M. | 50 Hz

RR RENTAL RANGE

Scope of supply



Engine/alternator assembly, coupled and installed on a heavy electric wilded steel profile base frame through antivibration pad, then treated with rust removing products for zink layer application and Polyester (QUALICOAT) painting, "special treatment for external and corrosive environment."

Soundproof canopy treated with rust removing products for zink layer application and Polyester (QUALICOAT) painting, "special treatment for external and corrosive environment." Then lined with rock wool material of high density.

Liquid cooled engine with integrated mechanical radiator and blower fan.

Integrated exhaust residential silencer of -35 db (A) antenuation, with rain cap protection.

Lifting hook crane.

Fork lift pockets for easy lifting from the bottom.

Hook for towing.

Radiator water filling cover register.

Easy acces to radiator cleaning, and replacement.

Integrated metallic fuel tank of 24 hours autonomy with liquid leakage protection.

Large fuel tank register for cleaning.

Fuel draining plug.

Internal fuel filler cap with security locable key.

Protection of heat, mobile, and live components.

Manual oil sump pump.

Baseframe prepared to be mounted on a trailer.

External emergency stop push button.

Engine starting battery "maintenance free" complete with wires connection, terminal protection and on-off switch.

Alternator battery charger with earth plug.

Self excited and auto regulated alternator.

Manual control panel with a microprocessor for control , protection and generating set reading parameters as voltage, amperage, working hours, etc.

Circuit breaker 4P and regulable earth leakage

Prepared for earth stud installation (earth stud not included).

Vertical outlet for hot air

On/off battery switch

Documents Bag

OPTIONS

Coolant preheating resistor.

Battery charger

Automatic/manual fuel transfer pump.

Total plus alternator protection.

Diferent colour.

External linkbox for arround cables.

Kit of 3-way valves for external fuel tank connection (optional single lever).

Fast fuel plug connection between external and internal fuel tanks

AMF/ATS panel to turn a manual gen set to automatic version.

Voltage and frequency change selector (50 Hz - 60 Hz).

Electrical power socket kit

Soundproof canopy auxiliary internal lighting

Rev.: 16/12/2019

Model: IKRN5-040 - RENTAL RANGE

400/230 V - THREE-PHASE | 1.500 R.P.M. | 50 Hz

DSE 7310 MKII MANUAL CONTROL PANEL

MANUAL CONTROL, PROTECTION AND DISTRIBUTION panel, assembled on the generator set in metal cabinet with a DSE 7310 MKII engine protection unit.



Image for guidance purposes.

It has the following:

1. EMERGENCY STOP PUSHBUTTON.

2. PROTECTIONS:

Magnetothermal Protection.

Earth Leak Protection

Protection fuses for control module

Rev.: 16/12/2019

Model: IKRN5-040 - RENTAL RANGE 400/230 V - THREE-PHASE | 1.500 R.P.M. | 50 Hz

DSE 7310 MKII MANUAL CONTROL PANEL

3. DSE 7310 MKII PROTECTION CONTROL MODULE.

LCD SCREEN:

It has a digital LCD screen, which provides easy reading of the information regarding the ENGINE, ALTERNATOR and CHARGING.

ENGINE:	ALTERNATOR AND CHARGE:
Coolant temperature	Voltages between phases and between phases and neutral.
Oil pressure	Intensities
Turning speed (rpm)	Frequency
Fuel level	Active Power (kW)
Battery voltage	Reactive Power (kVAr)
Battery alternator voltage.	Apparent Power (kVA)
Operating hours	Cos phi
Number of start-ups	Active energy meter (kW-h)

CONTROL OF THE SET:

START AND STOP the set MANUALLY.

Possibility of doing it AUTOMATICALLY via START ON SIGNAL.

Dual Mutual Standby

PROTECTION OF THE ENGINE AND ALTERNATOR, WITH THE ALARMS ACTIVATED:

ENGINE:	ALTERNATOR:
Low oil pressure	Low and High Voltage
High coolant temperature	Low and High Frequency
Low and High battery Voltage	Overload due to Intensity (A)
Failure of the alternator to charge batteries	Short-circuit
Low fuel level.	Negative Phase Sequence.
	Power Overload (KW-kVA)
	Load control:
	<ul style="list-style-type: none"> ▪ Connection and disconnection of artificial loads. ▪ Disconnection of non-essential loads

OTHER CHARACTERISTICS:

The real-time clock provides an exact record of events	Possibility of SMS text messages
Extensive number of configurable inputs and outputs.	Ethernet communication and simultaneous use of RS232 and RS 485 ports
Configurable alarms and timers.	Programmer Clock with multiple maintenance events which can be configured for the optimal operation of the engine. Weekly and/or monthly programming of up to 16 starts and stops per week.
USB connectivity	Enhanced PLC functionality.
Fully configurable via software and PC	Data logging function
Modbus RTU	The fuel consumption may be monitored on the screen and SMS messages with alarms and reports may be sent.

Rev.: 16/12/2019

Model: IKRN5-040 - RENTAL RANGE 400/230 V - THREE-PHASE | 1.500 R.P.M. | 50 Hz

DSE 7310 MKII MANUAL CONTROL PANEL

4. PROTECTIONS

MAGNETO. PROTECTION (A)	EARTH LEAK PROTECTION	DISTRIBUTION
50A, 4P	Electronic, adjustable	Power terminals

Rev.: 16/12/2019

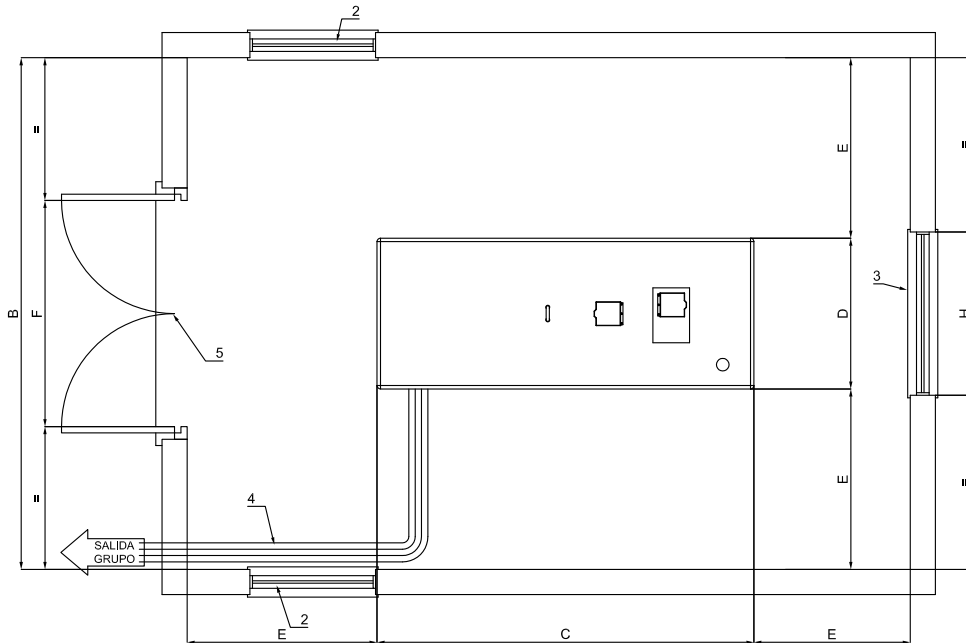
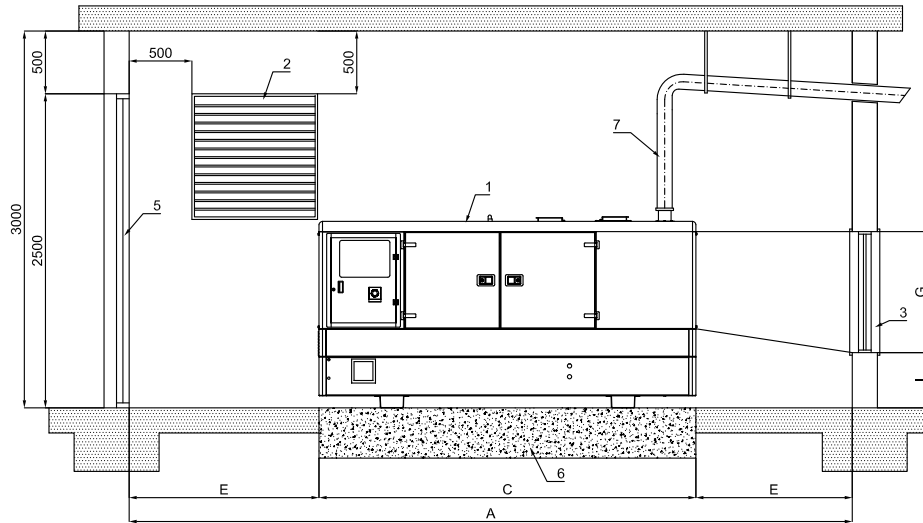

DIMENSIONES MINIMAS DE SALA SEGUN POTENCIA											
POTENCIA (Kva)	A	B	C	D	E	F	G	H	I	PESO	SECCION HUECO ENTRADA AIRE
8-15 ABATIBLE	3365	2800	1365	800	1000	900	700	850	450		2x0.50 m2
10-15	3600	2900	1600	900	1000	1100	700	850	450	804	2x0.50 m2
20-30	4000	2950	2000	950	1000	1200	750	850	450	980	2x0.50 m2
40-60-75	4500	3100	2500	1100	1000	1400	900	1100	450	1680	2x0.90 m2
85-105-130	5000	3200	3000	1200	1000	1400	900	1100	450	2120	2x1.00 m2
150-180-200-250	5600	3350	3600	1350	1000	1550	1150	1300	500	2340	2x2.50 m2
300-400	6200	3600	4200	1600	1000	1800	1250	1600	650	6340	2x3.00 m2
450-470-500-510-630-650	6800	4000	4800	2000	1000	2200	1300	1800	725	6900	2x3.50 m2

- NOMENCLATURA**
- 1.- GRUPO ELECTROGENO
 - 2.- HUECO ENTRADA DEL AIRE
 - 3.- TUNEL EXPULSION DEL AIRE
 - 4.- BANDEJA PASACABLES
 - 5.- PUERTA DE ACCESO
 - 6.- BASE HORMIGON ARMADO H-175
 - 7.- TUBO DE ESCAPE

CALCULO ESPESOR LOSA DE HORMIGON

$$E = \frac{W}{d \times D \times C}$$

E = altura bloque de hormigón
 W = peso total grupo electrógeno
 d = densidad del hormigón (2400 kg/m3)
 D = anchura bloque de hormigón (m)
 C = longitud bloque de hormigón (m)

h = 20/100 mm

EL Ø DE LA TUBERIA DE EXTENSION DEL ESCAPE PUEDE SER EL MISMO QUE EL DEL SILENCIADOR HASTA 5 m. PARA DISTANCAS MAYORES DE 5 m, DEBE AUMENTARSE EL Ø DE LA TUBERIA 10 mm POR CADA 10 m MAS DE DISTANCIA ENTRE EL GRUPO ELECTROGENO Y LA SALIDA EXTERIOR

		GRUPO INSONORIZADO			
MODIFICADO	A.AGUILAR	02-Ene-2015	MATERIAL		
DIBUJADO	J.G.BEJAR	27-Feb-2006	TOLERANCIA GENERAL		
COMPROBADO	J.L.SOLANO	04-Oct-2012	UDS.	Nº MOD.	
CODIGO	DENOMINACION:		EXPEDIENTE:	Nº PLANO	MARCA
PESO	GRUPO INSONORIZADO				
ESCALA	DIMENSIONES DE SALA				